

IO 2.0

→ FLAMINIA.

design **ALEXANDER DURINGER** e **STEFANO ROSINI**

2016

IOCW07

Coprivaso SLIM avvolgente in termoindurente a discesa rallentata
CON CERNIERE A SGANCIO RAPIDO

Complementi: Vaso IO 2.0 sospeso (IO118G)

Dim. Imballo

Peso **3,5 Kg**

Pz. Pallet n° -

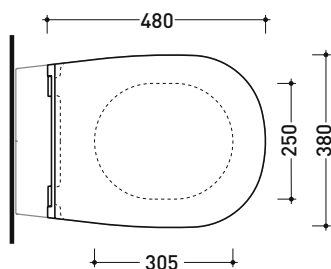

vista zenitale / zenital view

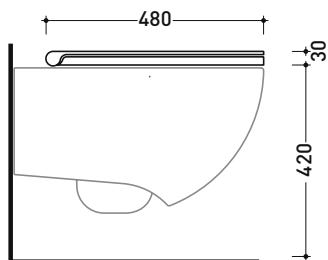

vista laterale / lateral view

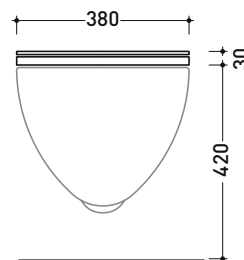

vista frontale / frontal view

dimensioni in mm

TERMOINDURENTE: finiture lucide



bianco



nero

finiture opache



latte



carbone